

**MAMMOTH**  
SECURITY

## JUNIOR BOLT - IN GROUND ANCHOR INSTRUCTIONS

**Please read instructions carefully** and retain for future reference.  
Failure to follow the instructions in this guide may result in damage to the product and / or personal injury.

It is the user's responsibility to check the ground anchor is routinely inspected to ensure it is secure and stable.

The Mammoth Junior Bolt-In Ground Anchor provides a robust base to chain bikes to

- Heavy-Duty ground anchor
- Simply bolts into concrete surface
- Manufactured from hardened steel
- Suitable for outdoor and indoor use

Product Code: **GRD005**



### PRODUCT CONTENTS

1. Ground Anchor Unit (1pc)
2. M10 Expander Allen Head Bolts (2pc)
3. Anti-Tamper Bearings (2pc)
4. Allen Key (1pc)

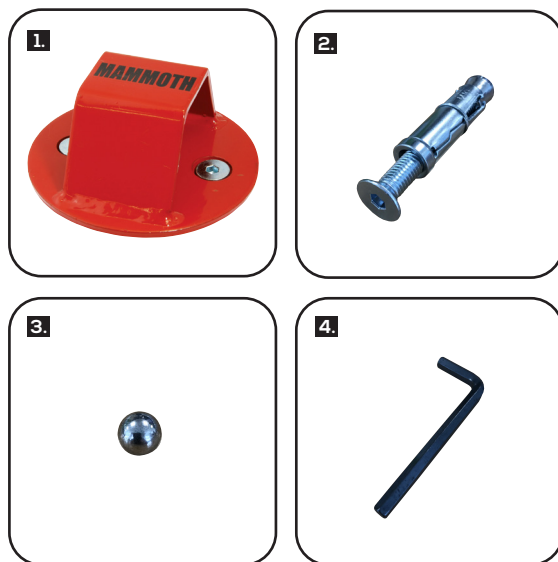

### TOOLS REQUIRED FOR FITTING

1. Electric Drill
2. 10mm Concrete Drill Bit
3. 16mm Concrete Drill Bit
4. Hammer

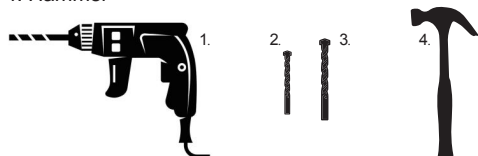

It is recommended to install the ground anchor near to a wall, or in a location that is not in constant use by pedestrians or vehicles.

#### STEP 1

The anchor must only be fitted into flat concrete ground which is sound and no less than 150mm depth.

If fitting the anchor near an edge of concrete ground, allow at least 30cm space to the first drill holes.

#### STEP 2

Place the anchor on the ground in the chosen location.

Use the 10mm drill bit and mark 2 pilot holes for the expander casings through the bolt holes.

#### STEP 3

Remove the anchor and use the 16mm drill bit to drill the 2 pilot holes to a depth of 80mm.

Insert each of the 2 expander casing into the 2 drill holes. Unscrew the Allen Head Bolts from the Expander Casings.

#### STEP 4

Place the ground anchor over the 2 drill holes in the ground and align with the bolt holes. Insert each of the allen head bolts into the drill holes and tighten as far as possible.

The expander bolts will splay out and secure into the concrete.

#### STEP 5

Ensure that the ground anchor is fully bolted into the concrete and that there are no gaps between the concrete surface and base of the anchor.

#### STEP 6

When the anchor is fully bolted into the ground, place an anti-tamper ball-bearing into each of the allen head holes on the top of each bolt.

Fully hammer all 2 bearings into each of the 2 allen head bolts – this will render the bolts unusable and deter would-be thieves from unscrewing the bolts.

#### STEP 7

The ground anchor is now ready for use.

It is also recommended to fill the remainder of the bolt holes with a "liquid metal" type product (not supplied) this will further help with locking in the expander casings into the concrete.